

Manual Bilge Pumps



Gusher® Urchin Compact Bilge and Waste Pump

On Deck/Bulkhead: BP9005 - Fixed Handle Compact Bilge & Waste Pump

On Deck/Bulkhead: BP9021 - Removable Handle Compact Bilge & Waste Pump

Note* Contained in Service Kit AK9003 (Neoprene™) or AK9011 (Nitrile®)

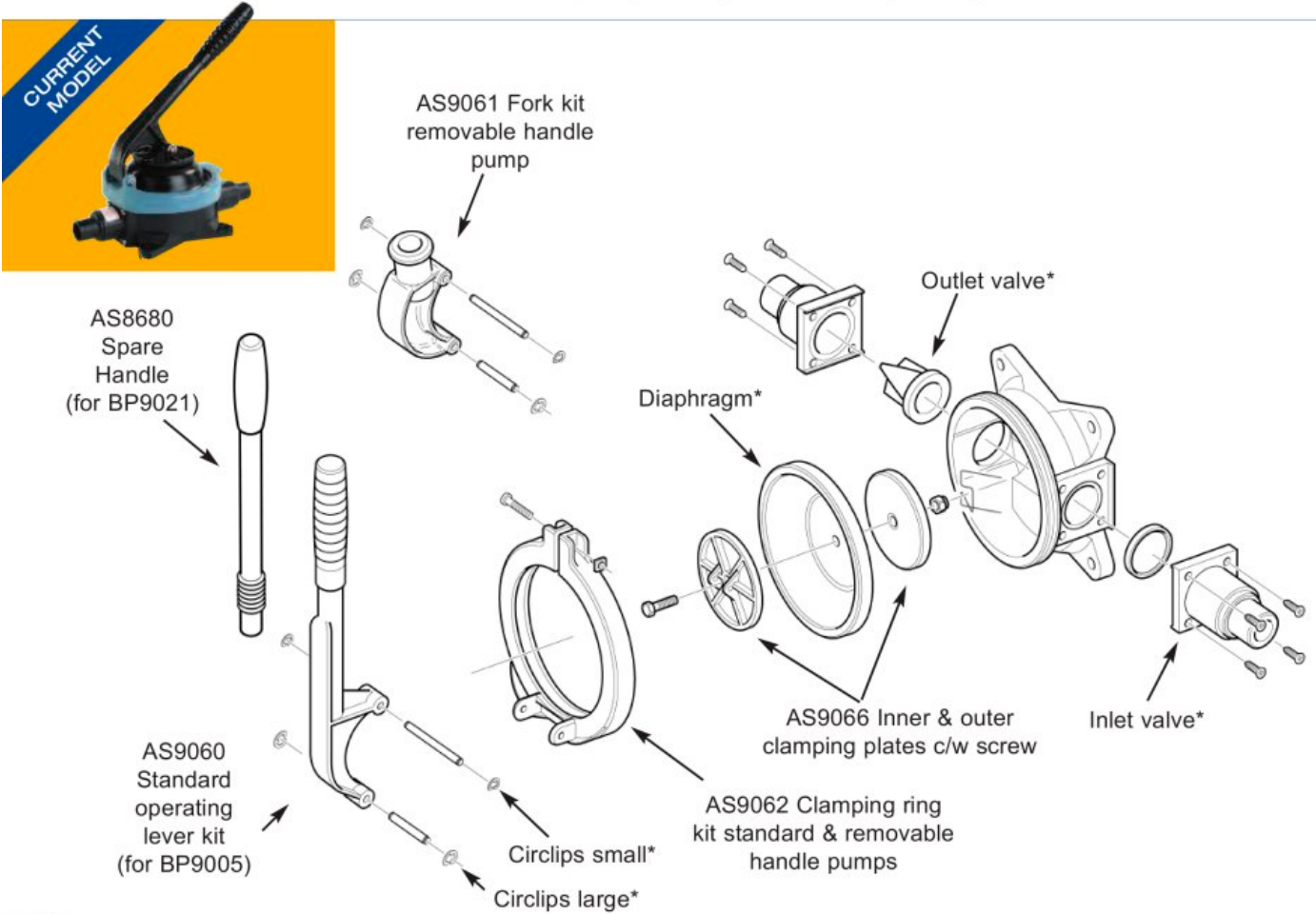

16

Accessories

- AS8680 Spare Handle (for BP9021 only)
- SB4222 Side Entry Strainer
- SB5865 Top Entry Strainer
- SF5204 1" Skin Fitting
- SF5425 1 1/2" Skin Fitting
- YP6114 1 1/2" Y Piece
- YP6130 1/2" Y Piece
- LV1215 1" / 1 1/2" Non Return Valve
- LV1219 3/4" / 1" Non Return Valve
- EB3364 1" Elbow
- EB3488 1 1/2" Elbow

Service Kits

- AK9003 Service Kit with Complete Set of Serviceable Parts for Urchin (Neoprene™)**
 - AK9011 Service Kit with Complete Set of Serviceable Parts for Urchin (Nitrile®)**
- | Qty | Containing |
|-----|---------------|
| 1 | Diaphragm |
| 1 | Inlet valve |
| 1 | Outlet valve |
| 2 | Circlip small |
| 2 | Circlip large |
-
- AS9060 Standard Operating Lever Kit**
- | Qty | Containing |
|-----|----------------------|
| 1 | Lever sleeve (black) |
| 1 | Lever |

- | | |
|---|---------------|
| 2 | Circlip small |
| 1 | Fulcrum pin |
-
- AS9061 Fork Assembly for Underdeck & Removable Handle Pumps**
- | Qty | Containing |
|-----|--------------------------------|
| 1 | Short fulcrum pin |
| 1 | Fork |
| 2 | Circlip small |
| 2 | Circlip large |
| 1 | Long fulcrum pin (underdeck) |
| 1 | Fulcrum pin (removable handle) |
-
- AS9062 Clamping Ring Kit for Standard & Removable Handle Pumps**
- | Qty | Containing |
|-----|---------------|
| 1 | Clamping ring |